

FIRST FLOOR PLUMBING FLOOR PLAN

SCALE: 1/4" = 1'-0"

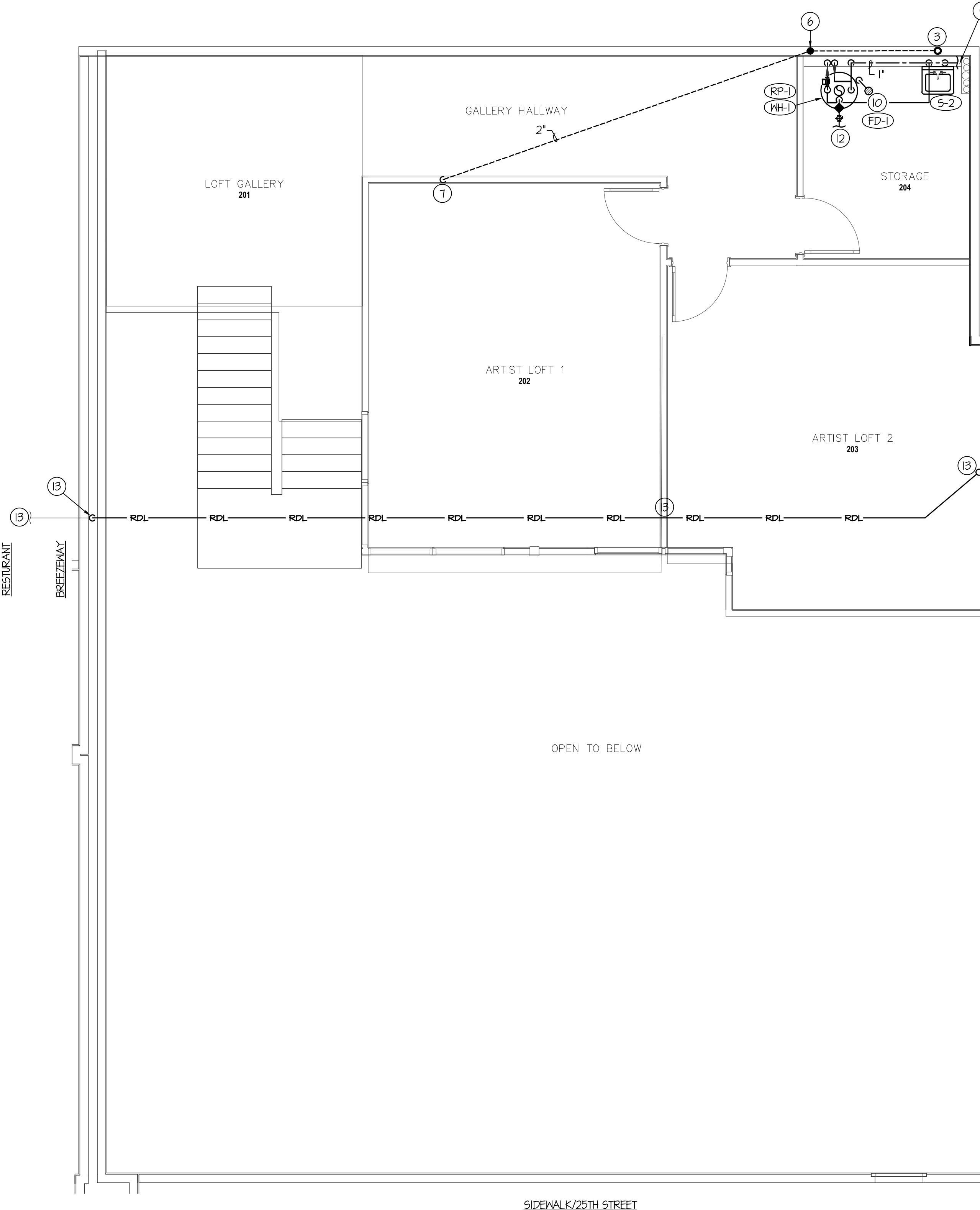
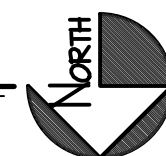

SECOND FLOOR PLUMBING FLOOR PLAN

SCALE: 1/4" = 1'-0"

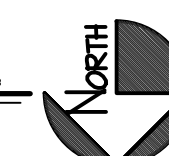

PLAN NOTES:

- 1 SAW CUT FLOOR AS REQUIRED FOR NEW WASTE LINE TO LOCATION AS SHOWN. FIELD VERIFY BEST POSSIBLE ROUTES.
- 2 FIELD VERIFY CLOSEST 4" WASTE LINE OR LARGER & TIE INTO SAW CUT SLAB AS REQUIRED. CORE DRILL FOR WASTE LINE DROP TO BELOW. SEE PATCHING DETAILS ON ARCHITECT PLANS.
- 3 DROP NEW 2" WASTE LINES IN LOCATION IN WALL AS SHOWN. SEE THIS SHEET FOR CONTINUATION.
- 4 SHIFT 2" WASTE LINE LATERALLY FROM ABOVE IN WALL TO LOCATION AS SHOWN.
- 5 2" VENT TO ABOVE. SEE THIS SHEET FOR CONTINUATION.
- 6 NEW 2" VTR IN AREA AS SHOWN ON PLANS. KEEP 10' FROM OPENING INTO BUILDING. SEE VTR PENETRATION DETAILS ON SHEET P201.
- 7 2" VENT FROM BELOW. SEE THIS SHEET FOR CONTINUATION.
- 8 NOT USED.
- 9 CONNECT NEW 1" WATER LINE TO NEAREST 1" OR LARGER IN THIS AREA AS SHOWN.
- 10 SEE FLOOR DRAIN DETAIL ON SHEET P201.
- 11 HOT WATER RE-CIRCULATION LINE TO BE WITHIN 6" OF PUBLIC LAV. DROP IN WALL AS REQUIRED.
- 12 RAISE NEW 1/2" 2PSI GAS LINE TO ROOF AND CONNECT TO NEAREST 1" OR LARGER. FIELD VERIFY EXISTING GAS LINE ROUTES, SIZES, AND PRESSURE. ALL GAS PIPING LOCATED ON ROOF TO BE INSTALLED ON PILLON BLOCK SIMILAR TO ERICO PIPE PIER SUPPORTS AT 10' ON CENTER. SEE DETAILS ON SHEET P3 FOR GAS CONNECTION DETAIL.
- 13 EXISTING ROOF DRAIN LINE IN THIS APPROXIMATE LOCATION. RAISE AS HIGH AS POSSIBLE AND DROP IN LOCATION AS SHOWN TO EXISTING LOCATION. TO BE PAINTED BY OTHERS.

GENERAL NOTES:

- A- THE CONTRACTOR SHALL CHECK AND VERIFY ALL DIMENSIONS AND CONNECTIONS ON THE JOB SITE. ALL WORK SHALL BE EXECUTED FROM MEASUREMENTS TAKEN AT THE SITE.
- B- THE MECHANICAL CONTRACTOR SHALL BE RESPONSIBLE TO INSURE PROPER CODE CLEARANCES FOR ELECTRICAL AND MECHANICAL ACCESS WHEN INSTALLING ANY EQUIPMENT SUPPLIED BY THE MECHANICAL CONTRACTOR.
- C- IT IS CRITICAL THAT THIS CONTRACTOR COORDINATE EQUIPMENT LOCATIONS WITH PIPING, DUCTWORK, ELECTRICAL CONDUIT AND BUILDING STRUCTURE TO INSURE CODE COMPLIANCE.
- D- CEILING DIFFUSERS ARE SHOWN IN APPROXIMATE LOCATIONS. REFER TO LIGHTING PLANS AND REFLECTED CEILING PLAN FOR EXACT LOCATIONS.
- E- DUCT DIMENSIONS CALLED OUT ON DRAWINGS ARE INSIDE FREE AREA DIMENSIONS. ACOUSTICAL DUCT LINER ARE TO BE ADDED TO OVERALL MEASUREMENTS.
- F- ALL DUCTWORK AND PIPING WHICH PASSES THRU FIRE RATED WALLS TO BE FIRE STOPPED WITH APPROVED FOAM OR SEALANT. REFER TO SPECIFICATIONS FOR APPROVED MANUFACTURES.

PLUMBING LEGEND

| SYMBOL | DESCRIPTION |
|--------|----------------------------|
| V | VENT |
| VTR | VENT THRU ROOF |
| CO | CLEANOUT |
| WCO | WALL CLEANOUT |
| COTG | CLEANOUT TO GRADE |
| — | PIPE DROP |
| — | PIPE RISE |
| — | BALL TYPE ISOLATION VALVE |
| --- | SOIL OR WASTE PIPING |
| --- | VENT LINE PIPING |
| --- | DOMESTIC COLD WATER PIPING |
| --- | DOMESTIC HOT WATER PIPING |
| --- | HOT WATER RECIRC. PIPING |
| —G— | GAS PIPING |
| —CD— | CONDENSATE DRAIN PIPING |
| —RDL— | ROOF DRAIN PIPING |
| —RDO— | ROOF OVERFLOW DRAIN PIPING |



| REV | DATE | DESCRIPTION |
|-----|------|-------------|
| | | |
| | | |
| | | |
| | | |

Tenant Improvement For:
01 Arts Xibit Gallery
 455 25th Street
 Ogden, Utah 84411

PROJECT: MOUNTAIN WEST ARCHITECTURE | 1543 25TH STREET - OGDEN, UT 84411 | PH: 801-388-6052 | WWW.MOUNTAINWESTARCHITECTURE.COM

SHEET TITLE:
PLUMBING FLOOR PLAN
 PROJECT: FAYES LAUNDRY

SHEET NUMBER:

P101

DO NOT SCALE DRAWING

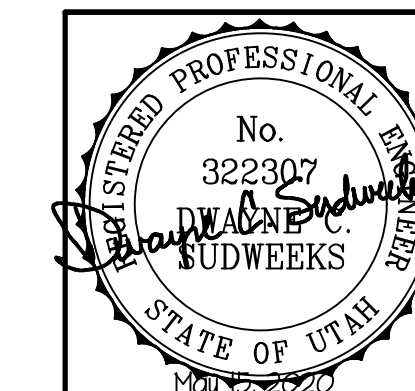

Engineered Systems Associates
 1355 EAST CENTER
 POCATELLO, IDAHO 83201
 PHONE: (208) 233-0501
 FAX: (208) 233-0529
 EMAIL: esa@engsystems.com
 ESA JOB NUMBER: 20036